

BALDHEAD

GARAGE ENHANCEMENT SYSTEMS



BALDHEAD PRICE LIST AND SPECIFICATION SHEET

V4.1.2006

WELCOME TO BALDHEAD CABINET COMPANY

THANK YOU FOR THE OPPORTUNITY TO SHARE INFORMATION WITH YOU ON WHAT WE FEEL ARE THE BEST METAL GARAGE CABINETS IN THE BUSINESS. ENCLOSED, YOU WILL FIND DETAILS ON AN EXTENSIVE VARIETY OF SIZES AND MODULES, ALLOWING YOU TO DESIGN THE PERFECT LAYOUT FOR A GARAGE OR SHOP. BALDHEAD CABINET COMPANY MANUFACTURES ALL OUR CABINETS IN THE USA WITH AN ONGOING COMMITMENT TO OFFER CLIENTS THE HIGHEST QUALITY AVAILABLE.

PLEASE CALL ONE OF OUR QUALIFIED DEALERS IF YOU HAVE ANY QUESTIONS OR WOULD LIKE TO DISCUSS YOUR PARTICULAR REQUIREMENTS.

ERIC FLEMING
PRESIDENT
BALDHEAD CABINET COMPANY
WWW.BALDHEADCABINETS.COM

ORDERING INFORMATION



#H = PULL HANDLE



#P = POCKET HANDLE

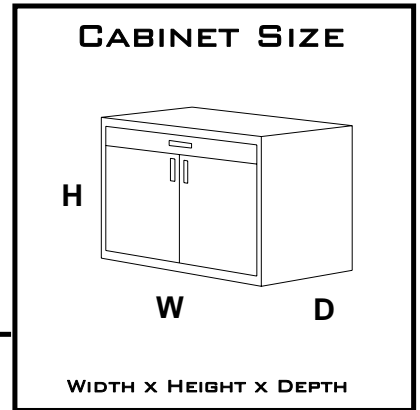

#H-7D363224-M-BLKRED

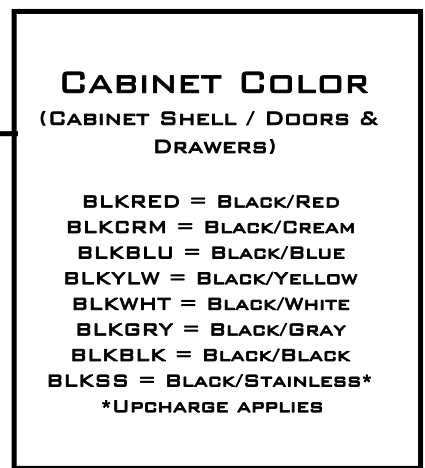
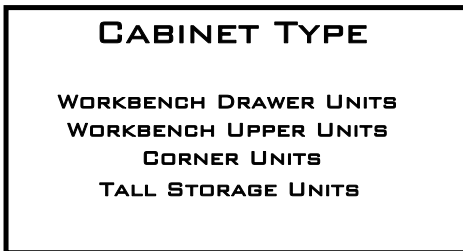

TRADITIONAL METAL SERIES

WORKBENCH HEIGHT BASE CABINETS

SPECIFICATIONS:

WORKBENCH HEIGHT BASE CABINETS ARE TO BE MOUNTED ON A 2", 4", 6", OR 8" KICK PLATE BASE, DEPENDING ON THE TOTAL HEIGHT REQUIRED

DEPTH OF CABINETS ARE 23.63"

WIDTHS VARY AS SHOWN NEXT TO THE PART NUMBERS BELOW

ALL DRAWERS ARE 22" DEEP, COMPLETE WITH FULL EXTENSION BALL BEARING SLIDES (100LB CAPACITY) AND NON-SLIP FOAM PADS

SHELVES ARE CAPABLE OF HOLDING UP TO 150LBS EACH

CABINETS ARE CONSTRUCTED OF 18GA. ELECTRO-GALVANIZED STEEL

ALL SURFACES ARE POWDER COATED WITH A BAKED-ON, TEXTURED POWDER

DRAWER FRONTS ARE DOUBLE WALLED FOR RIGIDITY AND TO OBTAIN A FINISHED LOOK, INSIDE AND OUT

DOORS ARE SUPPLIED WITH HIDDEN, EUROPEAN STYLE HINGES

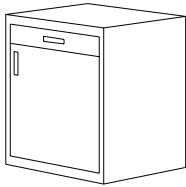

ONE DRAWER UNIT

- (1) 5.00" DRAWER
- (1) RH OR LH DOOR OR SET OF DOORS

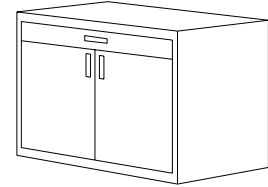

(1) SHELF
#1D243224LH OR RH (23.63" W x 31.50" H)

(1) SHELF
#1D363224 (35.43" W x 31.50" H)

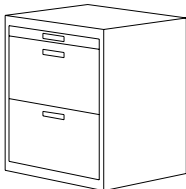

THREE DRAWER UNIT

- (1) 2.50" DRAWER
- (2) 12.50" DEEP FILE DRAWERS

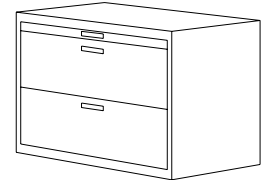

#3D243224 (23.63" W x 31.50" H)

#3D363224 (35.43" W x 31.50" H)



FIVE DRAWER UNIT

- (1) 2.50" DRAWER
- (2) 5.00" DEEP DRAWERS
- (2) 7.50" DEEP DRAWERS

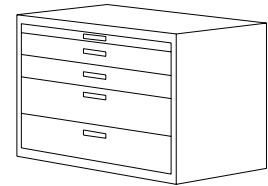

#5D243224 (23.63" W x 31.50" H)

#5D363224 (35.43" W x 31.50" H)

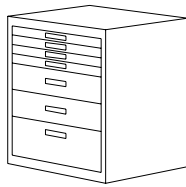

SEVEN DRAWER UNIT

- (4) 2.50" DRAWER
- (2) 5.00" DEEP DRAWERS
- (2) 7.50" DEEP DRAWERS

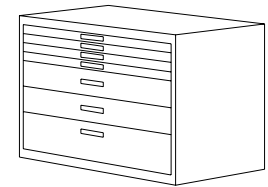

#7D243224 (23.63" W x 31.50" H)

#7D363224 (35.43" W x 31.50" H)

TRADITIONAL METAL SERIES

WORKBENCH HEIGHT BASE CABINETS - CONT.

SPECIFICATIONS:

WORKBENCH HEIGHT BASE CABINETS ARE TO BE MOUNTED ON A 2", 4", 6", OR 8" KICK PLATE BASE, DEPENDING ON THE TOTAL HEIGHT REQUIRED

DEPTH OF CABINETS ARE 23.63"

WIDTHS VARY AS SHOWN NEXT TO THE PART NUMBERS BELOW

ALL DRAWERS ARE 22" DEEP, COMPLETE WITH FULL EXTENSION BALL BEARING SLIDES (100LB CAPACITY) AND NON-SLIP FOAM PADS

SHELVES ARE CAPABLE OF HOLDING UP TO 150LBS EACH

CABINETS ARE CONSTRUCTED OF 18GA. ELECTRO-GALVANIZED STEEL

ALL SURFACES ARE POWDER COATED WITH A BAKED-ON, TEXTURED POWDER

DOOR AND DRAWER FRONTS ARE DOUBLE WALLED FOR RIGIDITY AND TO OBTAIN A FINISHED LOOK, INSIDE AND OUT

DOORS ARE SUPPLIED WITH HIDDEN, EUROPEAN STYLE HINGES

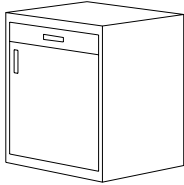

SINK UNIT

- (1) 5.00" STATIONARY FALSE FRONT
- (1) RH OR LH DOOR OR SET OF DOORS
- OPEN BACK AND TOP CUT OUT FOR SINK

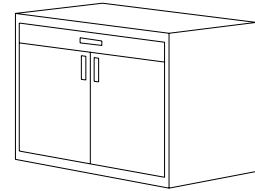

NO SHELVES

RH DOOR SHOWN

#SK243224LH OR RH (23.63" W x 31.50" H)

NO SHELVES

#SK363224 (35.43" W x 31.50" H)

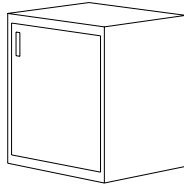

STORAGE UNIT

- (1) RH OR LH DOOR OR SET OF DOORS

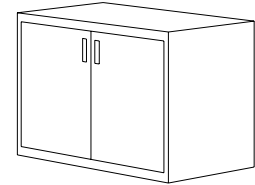

(1) SHELF

RH DOOR SHOWN

#S243224LH OR RH (23.63" W x 31.50" H)

(1) SHELF

#S363224 (35.43" W x 31.50" H)

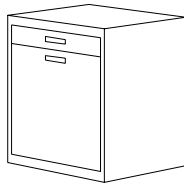

UTILITY SPORTS DRAWER UNIT

- (1) 5.00" DRAWER
- (1) 22.50" DEEP DRAWER

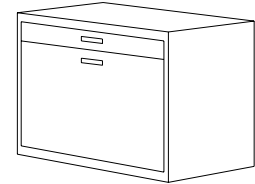

(1) SHELF

#US243224 (23.63" W x 31.50" H)

(1) SHELF

#US363224 (35.43" W x 31.50" H)

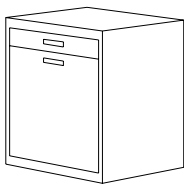

PET FOOD UNIT

- (1) 5.00" DRAWER
- (1) DRAWER WITH SEALED PLASTIC CONTAINERS FOR PET FOOD OR CAT LITTER

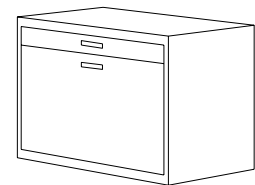

#PF243224 (23.63" W x 31.50" H)

#PF363224 (35.43" W x 31.50" H)

WORKBENCH HEIGHT BASE CABINETS - CONT.

SPECIFICATIONS:

WORKBENCH HEIGHT BASE CABINETS ARE TO BE MOUNTED ON A 2", 4", 6", OR 8" KICK PLATE BASE, DEPENDING ON THE TOTAL HEIGHT REQUIRED

DEPTH OF CABINETS ARE 23.63"

WIDTHS VARY AS SHOWN NEXT TO THE PART NUMBERS BELOW

ALL DRAWERS ARE 22" DEEP, COMPLETE WITH FULL EXTENSION BALL BEARING SLIDES (100LB CAPACITY) AND NON-SLIP FOAM PADS

SHELVES ARE CAPABLE OF HOLDING UP TO 150LBS EACH

CABINETS ARE CONSTRUCTED OF 18GA. ELECTRO-GALVANIZED STEEL

ALL SURFACES ARE POWDER COATED WITH A BAKED-ON, TEXTURED POWDER

DOOR AND DRAWER FRONTS ARE DOUBLE WALLED FOR RIGIDITY AND TO OBTAIN A FINISHED LOOK, INSIDE AND OUT

DOORS ARE SUPPLIED WITH HIDDEN, EUROPEAN STYLE HINGES

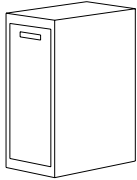

PULL-OUT FASTENER UNIT

INCLUDES (24) OR (48) PLASTIC BINS FOR FASTENERS OR SMALL PARTS

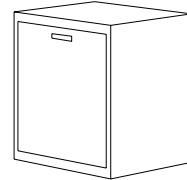

#PO123224 (11.81" W x 31.50" H)

#PO243224 (23.63" W x 31.50" H)

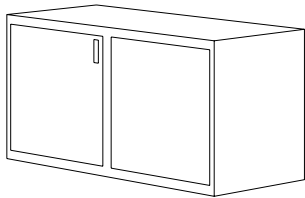

BLIND CORNER STORAGE UNIT

(1) RH OR LH DOOR
SPECIAL 165 DEGREE HINGES FOR INCREASED RANGE ON DOOR SWING

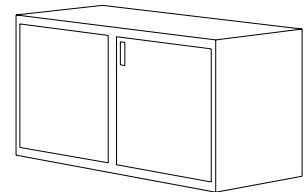

NO SHELVES

#CB483224LH (47.26" W x 31.50" H)

NO SHELVES

#CB483224RH (47.26" W x 31.50" H)

CORNER STORAGE UNIT

(1) SET OF DOORS

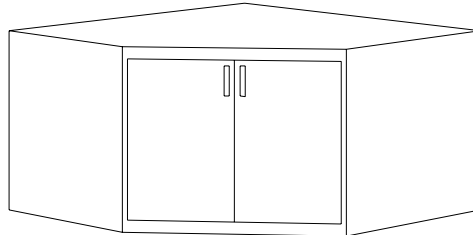

(1) SHELF

#C483248 (48.26 x 48.26" W x 31.50" H)

TRADITIONAL METAL SERIES

WORKBENCH UPPER CABINETS

SPECIFICATIONS:

WORKBENCH UPPER CABINETS ARE SHALLOW IN DEPTH TO ALLOW FOR HEAD ROOM ABOVE A WORKBENCH COUNTER SURFACE. SEVERAL CHOICES IN HEIGHTS AS SHOWN BELOW.

DEPTH OF CABINETS ARE 13.78"

WIDTHS VARY AS SHOWN NEXT TO THE PART NUMBERS BELOW

QUANTITY OF SHELVES PER ARE SHOWN NEXT TO EACH CABINET PICTURE

SHELVES ARE CAPABLE OF HOLDING UP TO 150LBS EACH

CABINETS ARE CONSTRUCTED OF 18GA. ELECTRO-GALVANIZED STEEL

ALL SURFACES ARE POWDER COATED WITH A BAKED-ON, TEXTURED POWDER

DOORS ARE DOUBLE WALLED FOR RIGIDITY AND TO OBTAIN A FINISHED LOOK, INSIDE AND OUT

DOORS ARE SUPPLIED WITH HIDDEN, EUROPEAN STYLE HINGES

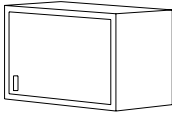

SINK HEIGHT UPPER UNIT

USE ABOVE A WORKBENCH SINK UNIT

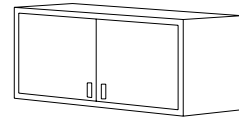

NO SHELVES

#SU241914LH OR RH (23.63" W x 18.90" H)

#SU361914 (35.43" W x 18.90" H)

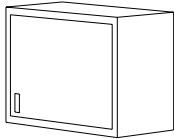

SHORT HEIGHT UPPER UNIT

USE WHEN MORE HEAD ROOM IS REQUIRED BETWEEN UPPER UNIT AND A WORKBENCH BASE UNIT

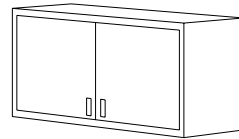

NO SHELVES

RH DOOR SHOWN

NO SHELVES

#SU242414LH OR RH (23.63" W x 23.63" H)

#SU362414 (35.43" W x 23.63" H)

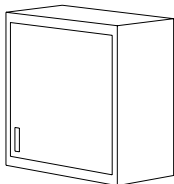

STANDARD HEIGHT UPPER UNIT

(1) RH OR LH DOOR OR SET OF DOORS

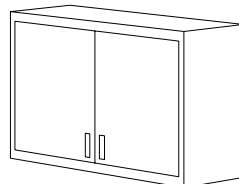

(1) SHELF

RH DOOR SHOWN

(1) SHELF

#SU243214LH OR RH (23.63" W x 31.50" H)

#SU363214 (35.43" W x 31.50" H)

TRADITIONAL METAL SERIES

WORKBENCH UPPER CABINETS - CONT.

SPECIFICATIONS:

WORKBENCH UPPER CABINETS ARE SHALLOW IN DEPTH TO ALLOW FOR HEAD ROOM ABOVE A WORKBENCH COUNTER SURFACE. SEVERAL CHOICES IN HEIGHTS AS SHOWN BELOW.

DEPTH OF CABINETS ARE 13.78"

WIDTHS VARY AS SHOWN NEXT TO THE PART NUMBERS BELOW

QUANTITY OF SHELVES PER ARE SHOWN NEXT TO EACH CABINET PICTURE

SHELVES ARE CAPABLE OF HOLDING UP TO 150LBS EACH

CABINETS ARE CONSTRUCTED OF 18GA. ELECTRO-GALVANIZED STEEL

ALL SURFACES ARE POWDER COATED WITH A BAKED-ON, TEXTURED POWDER

DOORS ARE DOUBLE WALLED FOR RIGIDITY AND TO OBTAIN A FINISHED LOOK, INSIDE AND OUT

DOORS ARE SUPPLIED WITH HIDDEN, EUROPEAN STYLE HINGES

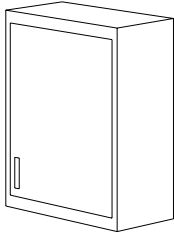

TALL HEIGHT UPPER UNIT

(1) RH OR LH DOOR OR SET OF DOORS

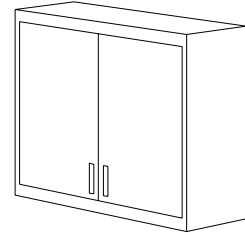

(2) SHELVES

RH DOOR SHOWN

#SU244514LH OR RH (23.63" W x 44.09" H)

(2) SHELVES

#SU364514 (35.43" W x 44.09" H)

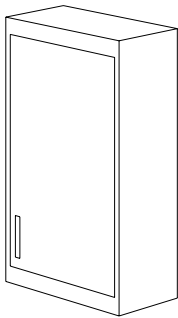

EXTRA TALL UPPER UNIT

(1) RH OR LH DOOR OR SET OF DOORS

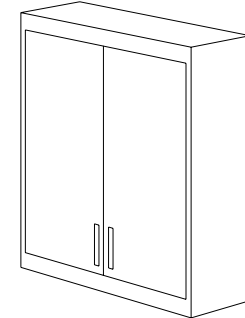

(2) SHELVES

RH DOOR SHOWN

#SU245114LH OR RH (23.63" W x 50.39" H)

(2) SHELVES

#SU365114 (35.43" W x 50.39" H)

WORKBENCH UPPER CABINETS - CONT.

SPECIFICATIONS:

WORKBENCH UPPER CABINETS ARE SHALLOW IN DEPTH TO ALLOW FOR HEAD ROOM ABOVE A WORKBENCH COUNTER SURFACE. SEVERAL CHOICES IN HEIGHTS AS SHOWN BELOW.

DEPTH OF CABINETS ARE 13.78"

WIDTHS VARY AS SHOWN NEXT TO THE PART NUMBERS BELOW

QUANTITY OF SHELVES PER ARE SHOWN NEXT TO EACH CABINET PICTURE

SHELVES ARE CAPABLE OF HOLDING UP TO 150LBS EACH

CABINETS ARE CONSTRUCTED OF 18GA. ELECTRO-GALVANIZED STEEL

ALL SURFACES ARE POWDER COATED WITH A BAKED-ON, TEXTURED POWDER

DOORS HAVE A DOUBLE WALLED SURROUND FOR RIGIDITY AND A FINISHED LOOK, INSIDE AND OUT

DOORS ARE SUPPLIED WITH HIDDEN, EUROPEAN STYLE HINGES

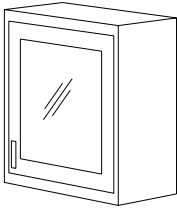

**STANDARD HEIGHT
GLASS DOOR UPPER UNIT**

(1) RH OR LH DOOR OR SET OF DOORS
WITH A PLEXIGLAS PANEL

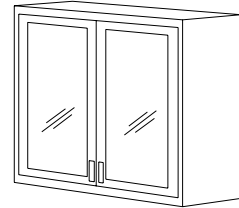

(1) SHELF

#GU243214LH OR RH (23.63" W x 31.50" H)

(1) SHELF

#GU363214 (35.43" W x 31.50" H)

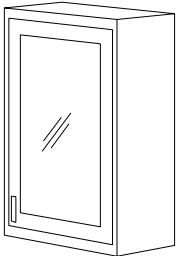

**TALL HEIGHT
GLASS DOOR UPPER UNIT**

(1) RH OR LH DOOR OR SET OF DOORS
WITH A PLEXIGLAS PANEL

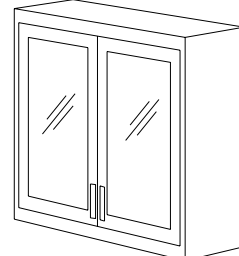

(2) SHELVES

#GU244514LH OR RH (23.63" W x 44.09" H)

(2) SHELVES

#GU364514 (35.43" W x 44.09" H)

TRADITIONAL METAL SERIES

WORKBENCH UPPER CORNER CABINETS

SPECIFICATIONS:

WORKBENCH UPPER CORNER CABINETS ARE SHALLOW IN DEPTH TO PROPERLY LINE UP WITH STANDARD UPPER CABINETS. SEVERAL CHOICES IN HEIGHTS AS SHOWN BELOW.

DEPTH OF CABINETS ARE 13.78"

WIDTHS VARY AS SHOWN NEXT TO THE PART NUMBERS BELOW

QUANTITY OF SHELVES PER ARE SHOWN NEXT TO EACH CABINET PICTURE

SHELVES ARE CAPABLE OF HOLDING UP TO 150LBS EACH

CABINETS ARE CONSTRUCTED OF 18GA. ELECTRO-GALVANIZED STEEL

ALL SURFACES ARE POWDER COATED WITH A BAKED-ON, TEXTURED POWDER

DOORS ARE DOUBLE WALLED FOR RIGIDITY AND TO OBTAIN A FINISHED LOOK, INSIDE AND OUT

DOORS ARE SUPPLIED WITH HIDDEN, EUROPEAN STYLE HINGES

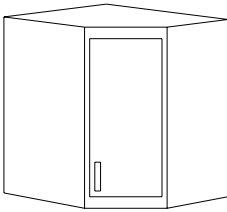

**STANDARD HEIGHT UPPER
CORNER UNIT**

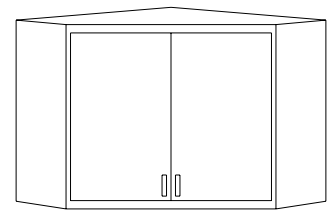

NO SHELVES **RH DOOR SHOWN**
-CU243224LH OR RH (23.63" W x 31.50" H)

NO SHELVES
#CU363236 (35.43" W x 31.50" H)

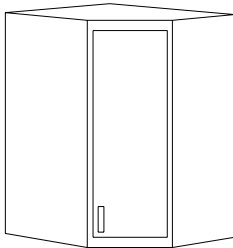

**TALL HEIGHT UPPER CORNER
UNIT**

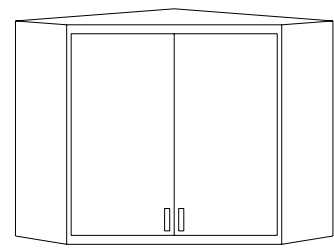

(2) SHELVES **RH DOOR SHOWN**
#CU244524LH OR RH (23.63" W x 44.09" H)

(2) SHELVES
#CU364536 (35.43" W x 44.09" H)

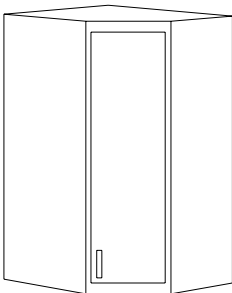

**EXTRA TALL UPPER
CORNER UNIT**

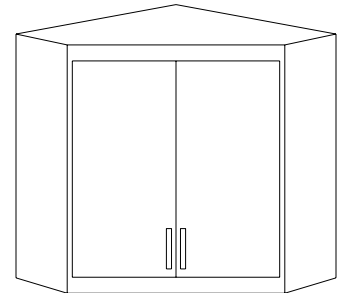

(2) SHELVES **RH DOOR SHOWN**
#CU245124LH OR RH (23.63" W x 50.39" H)

(2) SHELVES
#CU365136 (35.43" W x 50.39" H)

TRADITIONAL METAL SERIES

TALL STORAGE CABINETS

SPECIFICATIONS:

TALL STORAGE UNITS ARE TO BE MOUNTED ON A 2", 4", 6" OR 8" KICK PLATE BASE

A CHOICE OF 2 DEPTHS ARE AVAILABLE

WIDTHS VARY AS SHOWN NEXT TO THE PART NUMBERS BELOW

QUANTITY OF SHELVES PER ARE SHOWN NEXT TO EACH CABINET PICTURE

THESE CABINETS ARE PERFECT FOR BULK STORAGE NEEDS

CABINETS ARE CONSTRUCTED OF 18GA. ELECTRO-GALVANIZED STEEL

ALL SURFACES ARE POWDER COATED WITH A BAKED-ON, TEXTURED POWDER

DOORS ARE DOUBLE WALLED FOR RIGIDITY AND TO OBTAIN A FINISHED LOOK, INSIDE AND OUT

DOORS ARE SUPPLIED WITH HIDDEN, EUROPEAN STYLE HINGES

SHELVES ARE CAPABLE OF HOLDING UP TO 150LBS EACH AND ARE FULLY ADJUSTABLE IN 1.25" INCREMENTS

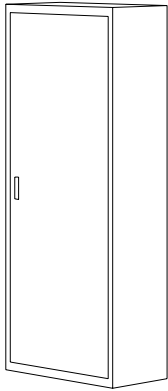

TALL STORAGE SHALLOW UNIT
13.78" DEPTH

(1) RH OR LH DOOR OR SET OF DOORS

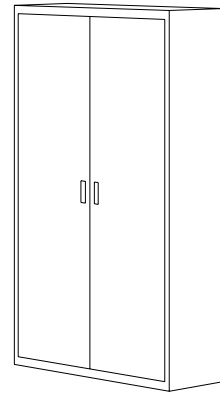

(4) SHELVES

RH DOOR SHOWN

#S248214LH OR RH (23.63" W x 81.89" H)

(4) SHELVES

#S368214 (35.43" W x 81.89" H)

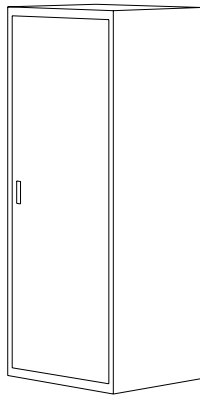

TALL STORAGE DEEP UNIT
23.63" DEPTH

(1) RH OR LH DOOR OR SET OF DOORS

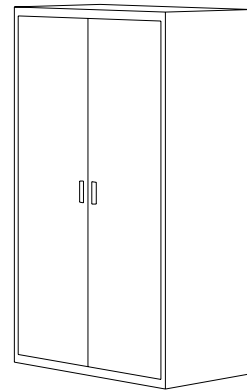

(4) SHELVES

RH DOOR SHOWN

#S248224LH OR RH (23.63" W x 81.89" H)

(4) SHELVES

#S368224 (35.43" W x 81.89" H)

TRADITIONAL METAL SERIES

TALL STORAGE CABINETS - CONT.

SPECIFICATIONS:

TALL STORAGE UNITS ARE TO BE MOUNTED ON A 2", 4", 6" OR 8" KICK PLATE BASE

A CHOICE OF 2 DEPTHS ARE AVAILABLE

WIDTHS VARY AS SHOWN NEXT TO THE PART NUMBERS BELOW

QUANTITY OF SHELVES PER ARE SHOWN NEXT TO EACH CABINET PICTURE

THESE CABINETS ARE IDEAL WHEN MOUNTED ADJACENT TO A HOME'S ENTRY DOOR FROM INSIDE THE GARAGE

CABINETS ARE CONSTRUCTED OF 18GA. ELECTRO-GALVANIZED STEEL

ALL SURFACES ARE POWDER COATED WITH A BAKED-ON, TEXTURED POWDER

DOORS ARE DOUBLE WALLED FOR RIGIDITY AND TO OBTAIN A FINISHED LOOK, INSIDE AND OUT

DOORS ARE SUPPLIED WITH HIDDEN, EUROPEAN STYLE HINGES

SHELVES ARE CAPABLE OF HOLDING UP TO 150LBS EACH AND ARE FULLY ADJUSTABLE IN 1.25" INCREMENTS

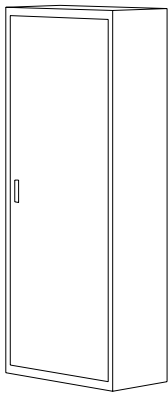

SHOE STORAGE UNIT

13.78" DEPTH

(1) RH OR LH DOOR OR SET OF DOORS
FULL BACK OF CABINET IS CEDAR LINED
INCLUDES EXTRA SHELVES TO ACCOMMODATE SHOES

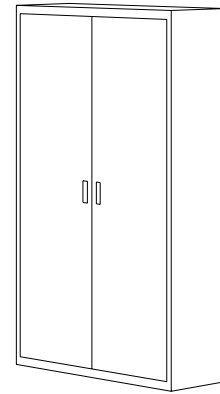

(8) SHELVES

RH DOOR SHOWN

#SS248214LH OR RH (23.63" W x 81.89" H)

(8) SHELVES

#SS368214 (35.43" W x 81.89" H)

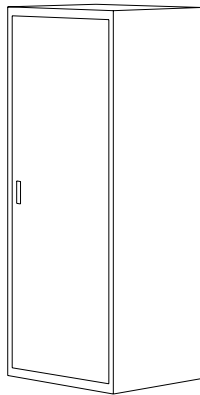

CLOSET STORAGE UNIT

23.63" DEPTH

(1) RH OR LH DOOR OR SET OF DOORS
FULL BACK OF CABINET IS CEDAR LINED
SUPPLIED WITH (2) HEIGHT ADJUSTABLE CLOTHES RODS

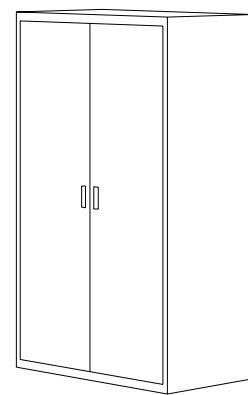

NO SHELVES

RH DOOR SHOWN

#CS248224LH OR RH (23.63" W x 81.89" H)

NO SHELVES

#CS368224 (35.43" W x 81.89" H)

TRADITIONAL METAL SERIES

TALL STORAGE CABINETS - CONT.

SPECIFICATIONS:

TALL STORAGE UNITS ARE TO BE MOUNTED ON A 2", 4", 6" OR 8" KICK PLATE BASE

A CHOICE OF 2 DEPTHS ARE AVAILABLE

WIDTHS VARY AS SHOWN NEXT TO THE PART NUMBERS BELOW

QUANTITY OF SHELVES PER ARE SHOWN NEXT TO EACH CABINET PICTURE

THESE CABINETS ARE PERFECT FOR STORING SKIS OR SNOWBOARDS

CABINETS ARE CONSTRUCTED OF 18GA. ELECTRO-GALVANIZED STEEL

ALL SURFACES ARE POWDER COATED WITH A BAKED-ON, TEXTURED POWDER

DOORS ARE DOUBLE WALLED FOR RIGIDITY AND TO OBTAIN A FINISHED LOOK, INSIDE AND OUT

DOORS ARE SUPPLIED WITH HIDDEN, EUROPEAN STYLE HINGES

SHELVES ARE CAPABLE OF HOLDING UP TO 150LBS EACH AND ARE FULLY ADJUSTABLE IN 1.25" INCREMENTS

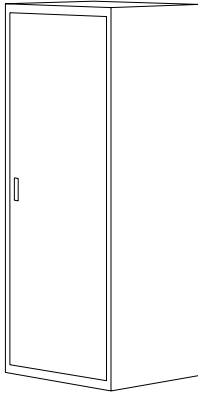

SKI STORAGE UNIT

23.63" DEPTH

(1) RH OR LH DOOR OR SET OF DOORS
SUPPLIED WITH (4) SKI OR SNOWBOARD BRACKET KITS
MOUNTED TO SIDE OF CABINET

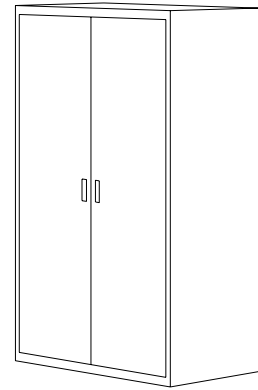

NO SHELVES

RH DOOR SHOWN

#SKE248224LH OR RH (23.63" W x 81.89" H)

NO SHELVES

#SKE368224 (35.43" W x 81.89" H)

CORNER STORAGE UNIT

23.63" DEPTH ON EACH SIDE

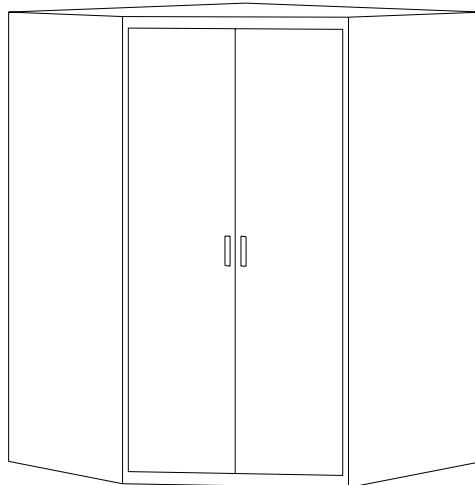

(4) SHELVES

#C488248 (47.26 x 47.26" W x 81.89" H)

TRADITIONAL METAL SERIES

CEILING HEIGHT STORAGE CABINETS

SPECIFICATIONS:

CEILING HEIGHT UPPER CABINETS ARE DESIGNED TO BE MOUNTED FLUSH WITH THE CEILING AND ARE FULL DEPTH TO ALLOW FOR MAXIMUM STORAGE. SEVERAL HEIGHTS ARE AVAILABLE

DEPTH OF CABINETS ARE 23.63"

WIDTHS VARY AS SHOWN NEXT TO THE PART NUMBERS BELOW

QUANTITY OF SHELVES PER ARE SHOWN NEXT TO EACH CABINET PICTURE

SHELVES ARE CAPABLE OF HOLDING UP TO 150LBS EACH

CABINETS ARE CONSTRUCTED OF 18GA. ELECTRO-GALVANIZED STEEL

ALL SURFACES ARE POWDER COATED WITH A BAKED-ON, TEXTURED POWDER

DOORS ARE DOUBLE WALLED FOR RIGIDITY AND TO OBTAIN A FINISHED LOOK, INSIDE AND OUT

DOORS ARE SUPPLIED WITH HIDDEN, EUROPEAN STYLE HINGES

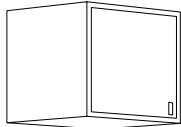

SHORT CEILING UNIT

(1) RH OR LH DOOR OR SET OF DOORS

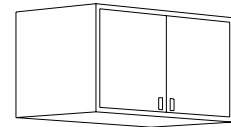

NO SHELVES

LH DOOR SHOWN

#SU242424LH OR RH (23.63" W x 23.63" H)

NO SHELVES

#SU362424 (35.43" W x 23.63" H)

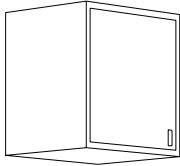

STANDARD CEILING UNIT

(1) RH OR LH DOOR OR SET OF DOORS

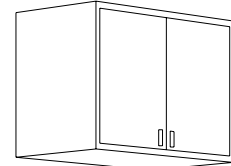

(1) SHELF

LH DOOR SHOWN

#SU243224LH OR RH (23.63" W x 31.50" H)

(1) SHELF

#SU363224 (35.43" W x 31.50" H)

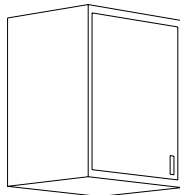

TALL CEILING UNIT

(1) RH OR LH DOOR OR SET OF DOORS

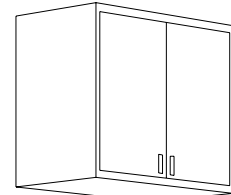

(2) SHELVES

LH DOOR SHOWN

#SU244524LH OR RH (23.63" W x 44.09" H)

(2) SHELVES

#SU364524 (35.43" W x 44.09" H)

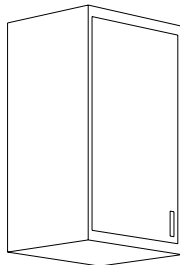

EXTRA TALL CEILING UNIT

(1) RH OR LH DOOR OR SET OF DOORS

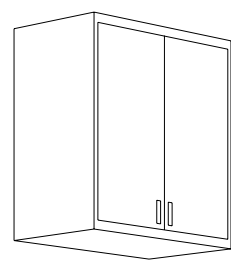

(2) SHELVES

LH DOOR SHOWN

#SU245124LH OR RH (23.63" W x 50.39" H)

(2) SHELVES

#SU365124 (35.43" W x 50.39" H)

STANDARD CABINET KICK PLATE BASES

SPECIFICATIONS:

VARIOUS SIZES ARE AVAILABLE TO ACCOMMODATE FOR DIFFERENT CONCRETE CURB OR BASEBOARD HEIGHTS

BASES ARE INSET IN FRONT FOR TOE SPACE AND IN BACK TO ALLOW FOR CONCRETE CURBS OR BASEBOARDS

WIDTHS VARY AS SHOWN NEXT TO THE PART NUMBERS BELOW

(4) ADJUSTABLE LEGS ARE SUPPLIED WITH EACH BASE TO ALLOW LEVELING OF CABINETS

BASES ARE CONSTRUCTED OF 18GA. ELECTRO-GALVANIZED STEEL

ALL SURFACES ARE POWDER COATED WITH A BAKED-ON, TEXTURED POWDER

VERTICAL REINFORCEMENTS ARE INTEGRATED IN THE BASE TO ENSURE CABINET STABILITY AND PROPER WEIGHT SUPPORT

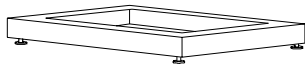

SHORT KICK PLATE BASE

2.00" HEIGHT WITH (4) 2.00" LEVEL LEGS



#KP240224 (23.63" W x 2.00" H x 18.50" D)

#KP360224 (35.43" W x 2.00" H x 18.50" D)

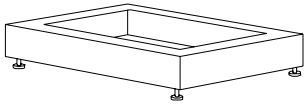

STANDARD KICK PLATE BASE

4.00" HEIGHT WITH (4) 4.00" LEVEL LEGS

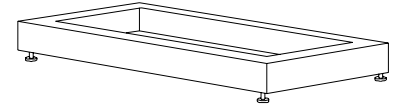

#KP240424 (23.63" W x 4.00" H x 18.50" D)

#KP360424 (35.43" W x 4.00" H x 18.50" D)

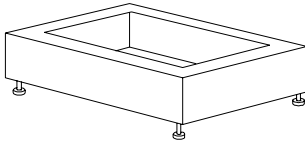

TALL KICK PLATE BASE

6.00" HEIGHT WITH (4) 4.00" LEVEL LEGS

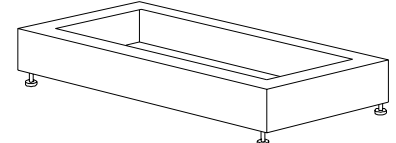

#KP240624 (23.63" W x 6.00" H x 18.50" D)

#KP360624 (35.43" W x 6.00" H x 18.50" D)

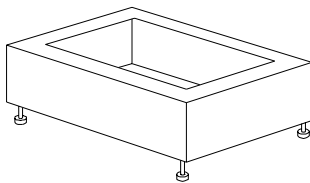

EXTRA TALL KICK PLATE BASE

8.00" HEIGHT WITH (4) 4.00" LEVEL LEGS

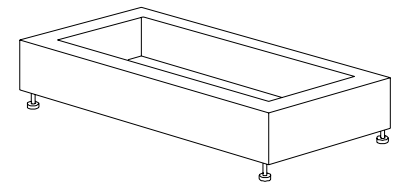

#KP240824 (23.63" W x 8.00" H x 18.50" D)

#KP360824 (35.43" W x 8.00" H x 18.50" D)

STANDARD CABINET KICK PLATE BASES - CONT.

SPECIFICATIONS:

VARIOUS SIZES ARE AVAILABLE TO ACCOMMODATE FOR DIFFERENT CONCRETE CURB OR BASEBOARD HEIGHTS

BASES ARE INSET IN FRONT FOR TOE SPACE AND IN BACK TO ALLOW FOR CONCRETE CURBS OR BASEBOARDS

WIDTHS VARY AS SHOWN NEXT TO THE PART NUMBERS BELOW

(4) ADJUSTABLE LEGS ARE SUPPLIED WITH EACH BASE TO ALLOW LEVELING OF CABINETS

BASES ARE CONSTRUCTED OF 18GA. ELECTRO-GALVANIZED STEEL

ALL SURFACES ARE POWDER COATED WITH A BAKED-ON, TEXTURED POWDER

VERTICAL REINFORCEMENTS ARE INTEGRATED IN THE BASE TO ENSURE CABINET STABILITY AND PROPER WEIGHT SUPPORT



#KP480224 (47.26" W x 2.00" H x 18.50" D)

SHORT KICK PLATE BASE

2.00" HEIGHT WITH (4) 2.00" LEVEL LEGS

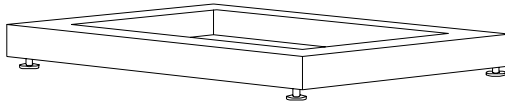

#KP480424 (47.26" W x 4.00" H x 18.50" D)

STANDARD KICK PLATE BASE

4.00" HEIGHT WITH (4) 4.00" LEVEL LEGS

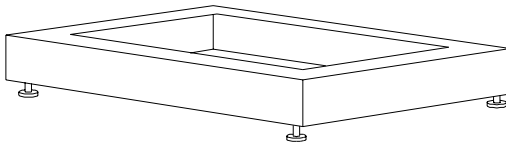

#KP480624 (47.26" W x 6.00" H x 18.50" D)

TALL KICK PLATE BASE

6.00" HEIGHT WITH (4) 4.00" LEVEL LEGS

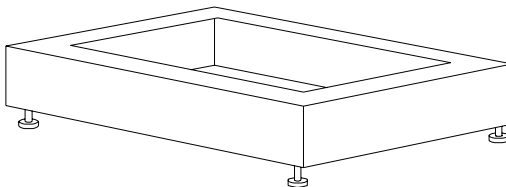

#KP480824 (47.26" W x 8.00" H x 18.50" D)

EXTRA TALL KICK PLATE BASE

8.00" HEIGHT WITH (4) 4.00" LEVEL LEGS

SHALLOW CABINET KICK PLATE BASES

SPECIFICATIONS:

VARIOUS SIZES ARE AVAILABLE TO ACCOMMODATE FOR DIFFERENT CONCRETE CURB OR BASEBOARD HEIGHTS AND ARE FOR USE ONLY ON SHALLOW DEPTH CABINETS

BASES ARE INSET IN FRONT FOR TOE SPACE AND IN BACK TO ALLOW FOR CONCRETE CURBS OR BASEBOARDS

WIDTHS VARY AS SHOWN NEXT TO THE PART NUMBERS BELOW

(4) ADJUSTABLE LEGS ARE SUPPLIED WITH EACH BASE TO ALLOW LEVELING OF CABINETS

BASES ARE CONSTRUCTED OF 18GA. ELECTRO-GALVANIZED STEEL

ALL SURFACES ARE POWDER COATED WITH A BAKED-ON, TEXTURED POWDER

VERTICAL REINFORCEMENTS ARE INTEGRATED IN THE BASE TO ENSURE CABINET STABILITY AND PROPER WEIGHT SUPPORT



SHORT KICK PLATE BASE

2.00" HEIGHT WITH (4) 2.00" LEVEL LEGS



#KP240214 (23.63" W x 2.00" H x 8.00" D)

#KP360214 (35.43" W x 2.00" H x 8.00" D)

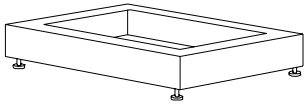

STANDARD KICK PLATE BASE

4.00" HEIGHT WITH (4) 4.00" LEVEL LEGS



#KP240414 (23.63" W x 4.00" H x 8.00" D)

#KP360414 (35.43" W x 4.00" H x 8.00" D)

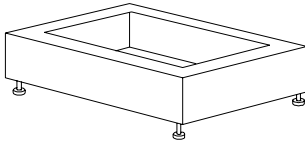

EXTENDED KICK PLATE BASE

6.00" HEIGHT WITH (4) 4.00" LEVEL LEGS

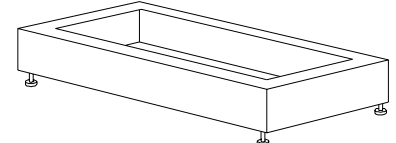

#KP240614 (23.63" W x 6.00" H x 8.00" D)

#KP360614 (35.43" W x 6.00" H x 8.00" D)

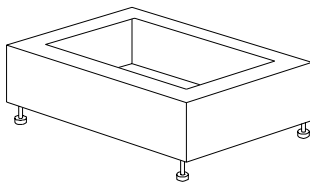

EXTRA HIGH KICK PLATE BASE

8.00" HEIGHT WITH (4) 4.00" LEVEL LEGS

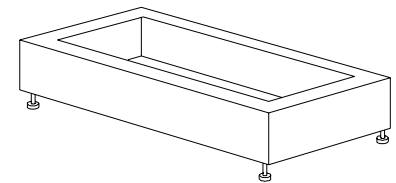

#KP240814 (23.63" W x 8.00" H x 8.00" D)

#KP360814 (35.43" W x 8.00" H x 8.00" D)

TRADITIONAL METAL SERIES

WORKBENCH TOPS

SPECIFICATIONS:

VARIOUS LENGTHS ARE AVAILABLE AS SHOWN BELOW

BOTH WOOD AND STAINLESS TOPS ARE 1.5" IN THICKNESS

WOOD TOPS ARE CONSTRUCTED FROM SOLID MAPLE BUTCHER BLOCK AND THEN COATED WITH AN EXTREMELY DURABLE, FACTORY APPLIED VARNIQUE FINISH

- #TP2425 (23.63" L x 25" D)
- #TP3625 (35.43" L x 25" D)
- #TP4825 (47.26" L x 25" D)
- #TP6025 (59.06" L x 25" D)
- #TP7225 (70.86" L x 25" D)
- #TP8425 (82.69" L x 25" D)
- #TP9625 (94.52" L x 25" D)
- #TP10825 (106.29" L x 25" D)
- #TP12025 (118.13" L x 25" D)
- #TP13225 (129.92" L x 25" D)
- #TP14425 (141.75" L x 25" D)

WORKBENCH TOPS -
MAPLE BUTCHER BLOCK

1.50" THICK SOLID MAPLE
DURABLE VARNIQUE FINISH

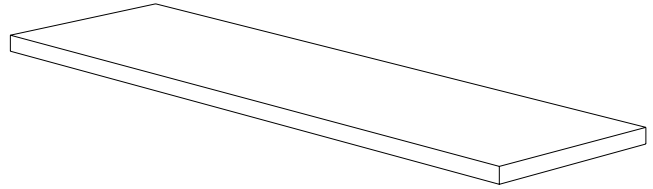

- #TP2425SS (23.63" L x 25" D)
- #TP3625SS (35.43" L x 25" D)
- #TP4825SS (47.26" L x 25" D)
- #TP6025SS (59.06" L x 25" D)
- #TP7225SS (70.86" L x 25" D)
- #TP8425SS (82.69" L x 25" D)
- #TP9625SS (94.52" L x 25" D)

WORKBENCH TOPS -
STAINLESS STEEL

12 GAUGE #4 FINISH STAINLESS

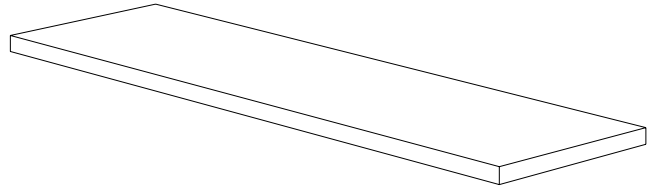

#TPCNR4825 (47.26" x 47.26" x 23.63)

FOR USE WITHOUT A CORNER BASE CABINET, A
SUPPORT BRACKET KIT, #TPCNR4825BK MUST BE
ORDERED

WORKBENCH TOPS -
CORNER BUTCHER BLOCK

1.50" THICK SOLID MAPLE
DURABLE VARNIQUE FINISH

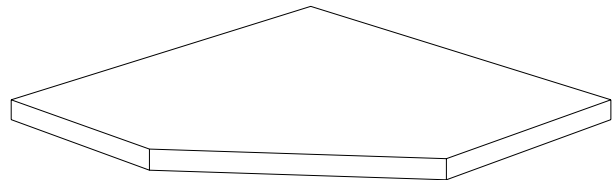

TRADITIONAL METAL SERIES

WORKBENCH TOPS - SINK UNIT

SPECIFICATIONS:

VARIOUS LENGTHS ARE AVAILABLE AS SHOWN BELOW

STAINLESS TOPS ARE 1.5" IN THICKNESS

#TPSK2425SS (23.63" L x 25" D)
#TPSK3625SS (35.43" L x 25" D)

STAINLESS WORKBENCH TOP
WITH STAINLESS STEEL SINK

12 GAUGE #4 FINISH STAINLESS STEEL
INCLUDES S.S. SINK BOWL

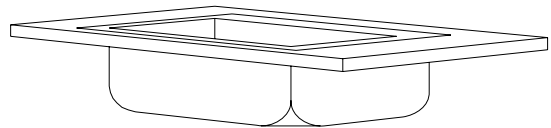

ACCESSORIES

SPECIFICATIONS:

LIGHT BARS AND PULL-OUT SHELVES ARE POWDER COATED WITH A BAKED-ON, TEXTURED POWDER AND ARE CONSTRUCTED WITH 18GA. ELECTRO-GALVANIZED STEEL

BACKSPLASHES ARE CONSTRUCTED OF DURABLE, MIRROR FINISHED DIAMOND PLATE ALUMINUM

#LB48 (47.26" LONG)
#LB60 (58.06" LONG)
#LB72 (70.86" LONG)
#LB84 (82.69" LONG)
#LB96 (94.52" LONG)

LIGHT BAR WITH PLUG STRIP

COMPLETE WITH CENTER MOUNTED
ON/OFF SWITCH AND
(2) DUPLEX PLUG OUTLETS

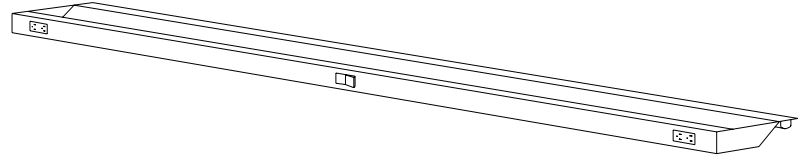

#DA3618 (35.43" L x 18" H)
#DA4818 (47.26" L x 18" H)
#DA6018 (59.06" L x 18" H)
#DA7218 (70.86" L x 18" H)
#DA8418 (82.69" L x 18" H)
#DA9618 (94.52" L x 18" H)

DIAMOND ALUMINUM WORKBENCH BACKSPLASH

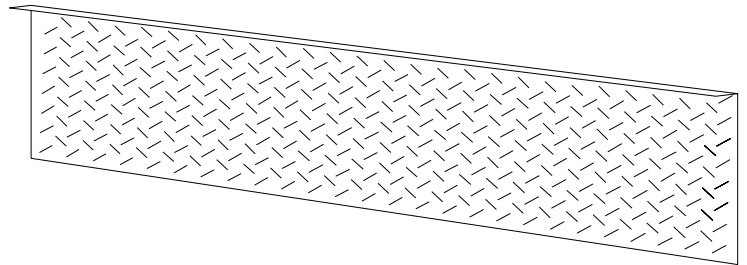

PULL-OUT SHELVES

COMPLETE WITH 22" DEEP, FULL
EXTENSION SLIDES, CAPABLE OF
REPLACING ANY STATIONARY SHELF

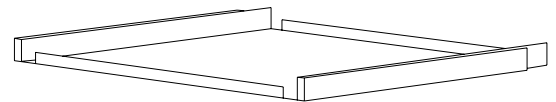
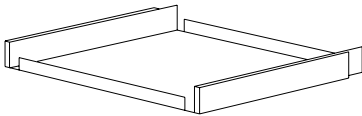

#POSF2424 (23.63" W x 23.63" D)

#POSF3624 (35.43" W x 23.63" D)

TRADITIONAL METAL SERIES

LOCKABLE ROLLING TOOL CARTS

SPECIFICATIONS:

ROLLING TOOL CARTS ARE CONFIGURED AS STANDARD WITH KEY LOCKABLE DRAWERS AND PULL-OUT SECTIONS

CASTERS ARE EXTRA HEAVY-DUTY WITH SMOOTH ROLLING, BLACK RUBBER MOUNTED ON STEEL, BALL BEARING FITTED WHEELS.

SWIVEL CASTERS UTILIZE A STANDARD LOCKING FEATURE TO PREVENT CART MOVEMENT DURING USE

STURDY BRUSHED ALUMINUM HANDLES ARE MOUNTED TO THE SWIVEL END(S) OF THE CART TO ALLOW EASY MOVEMENT, EVEN WHEN LOADED WITH THE HEAVIEST OF TOOLS AND EQUIPMENT

CARTS ARE CONSTRUCTED OF 18GA. ELECTRO-GALVANIZED STEEL

ALL SURFACES ARE POWDER COATED WITH A BAKED-ON, TEXTURED POWDER

DOORS ARE DOUBLE WALLED FOR RIGIDITY AND TO OBTAIN A FINISHED LOOK, INSIDE AND OUT

CHOOSE FROM 1.5" THICK MAPLE BUTCHER BLOCK OR 1.5" FORMED 12GA STAINLESS STEEL FOR THE ROLLING TOOL CART WORK SURFACE.



24" FIVE DRAWER WITH PULL-OUT UNIT

LOCKABLE DRAWERS AND PULL-OUT
(2) SWIVEL AND (2) STATIONARY CASTERS
TP = MAPLE BUTCHER BLOCK
SS = 12GA STAINLESS STEEL

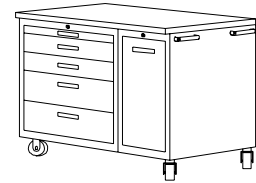

#LKR5D2432PO1232TP

#LKR5D2432PO1232SS

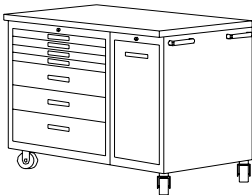

24" SEVEN DRAWER WITH PULL-OUT UNIT

LOCKABLE DRAWERS AND PULL-OUT
(2) SWIVEL AND (2) STATIONARY CASTERS
TP = MAPLE BUTCHER BLOCK
SS = 12GA STAINLESS STEEL

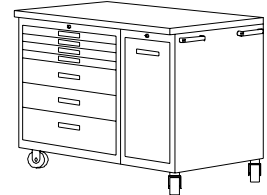

#KR7D2432PO1232TP

#LKR7D2432PO1232SS

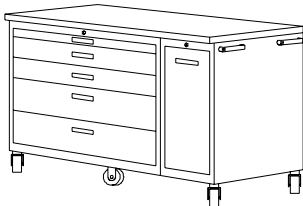

36" FIVE DRAWER WITH PULL-OUT UNIT

LOCKABLE DRAWERS AND PULL-OUT
(4) SWIVEL AND (2) STATIONARY CASTERS
TP = MAPLE BUTCHER BLOCK
SS = 12GA STAINLESS STEEL



#LKR5D3632PO1232TP

#LKR5D3632PO1232SS

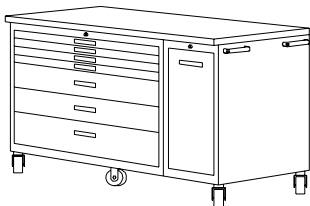

36" SEVEN DRAWER WITH PULL-OUT UNIT

LOCKABLE DRAWERS AND PULL-OUT
(4) SWIVEL AND (2) STATIONARY CASTERS
TP = MAPLE BUTCHER BLOCK
SS = 12GA STAINLESS STEEL



#LKR7D3632PO1232TP

#LKR7D3632PO1232SS